

Détail 1:1 barre de charge occulte Ø20

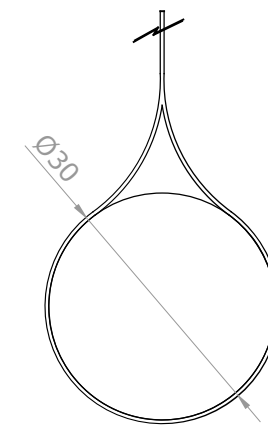

Détail 1:1 barre de charge occulte Ø30

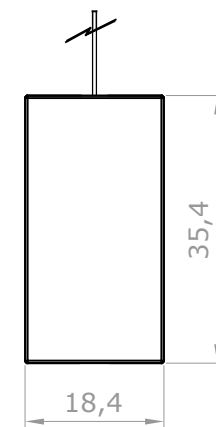

Détail 1:1 barre de charge apparente Slim 35

F. REVIS.		BANDALUX	
REVISION	1 2 3 4 5 6 7 8 9		
DATE	29-06-2017	PLAN N°	
DESSIN	Antonio F.	FORMAT	A-3
ECHELLE	Store enrouleur avec coffre B-Box 100 moteur coulisses U-302 Installation latérale Mécanisme: Moteur 40 Barre de charge: Occulte de Ø20mm Tube Ø44mm		
1/1			

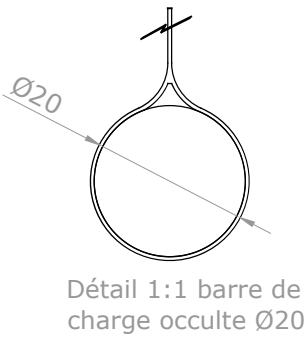
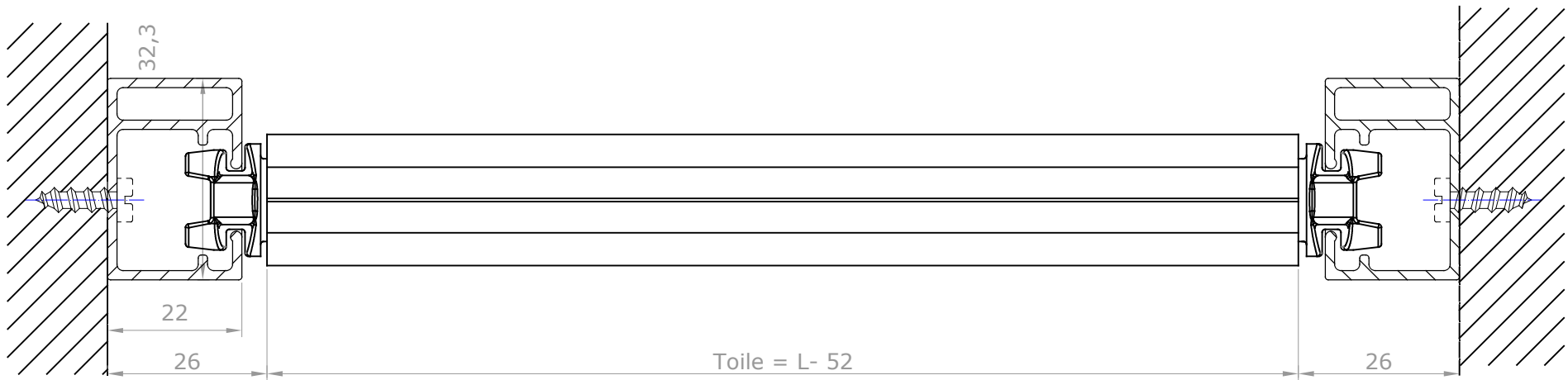
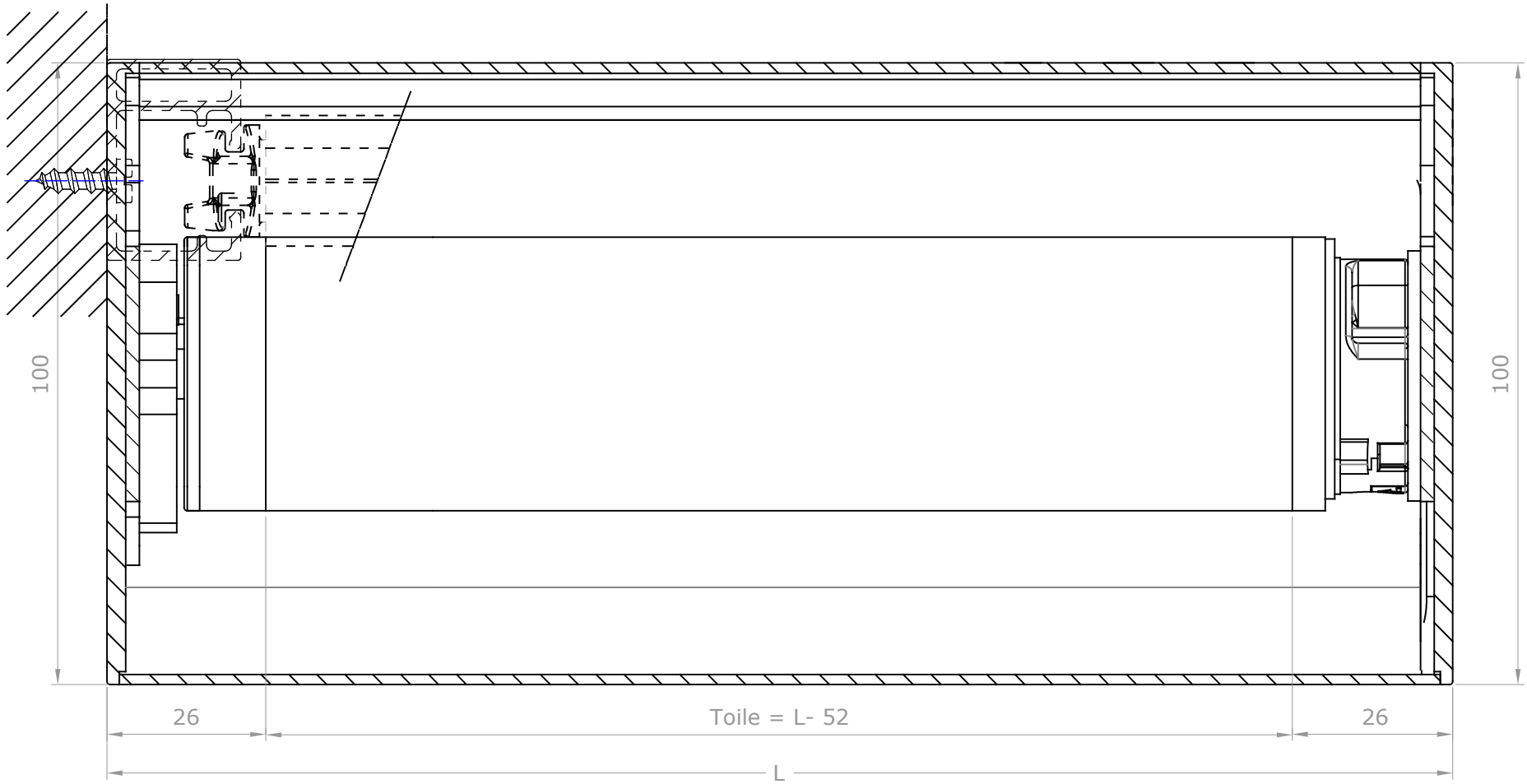
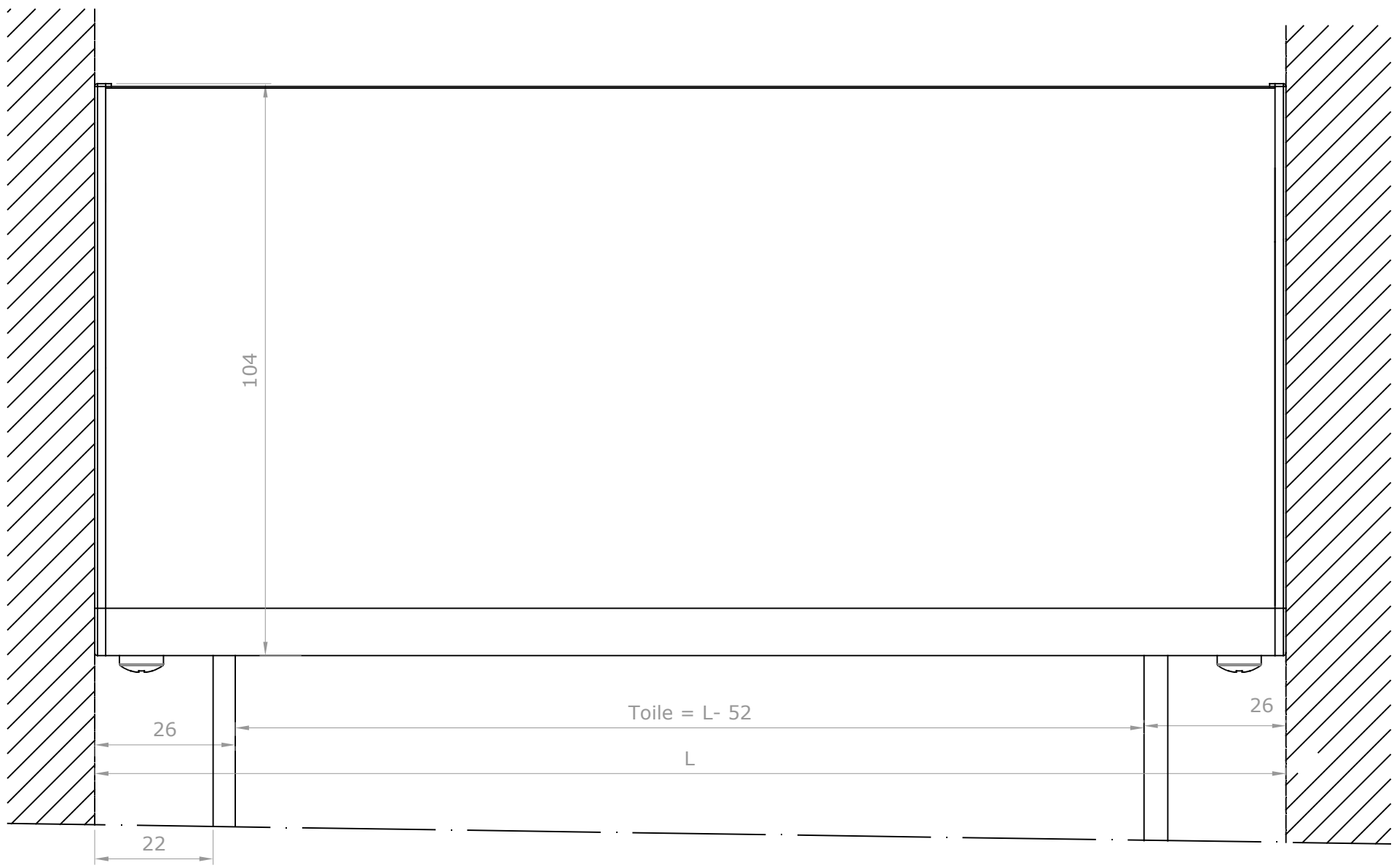

Détail 1:1 barre de charge occulte Ø20

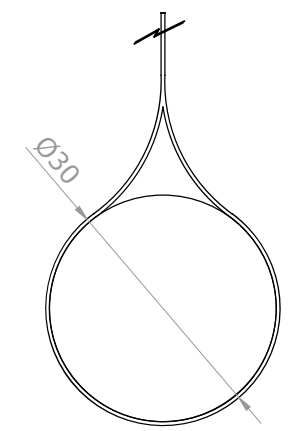

Détail 1:1 barre de charge occulte Ø30

F. REVIS.		BANDALUX	
REVISION	123456789		
DATE	29-06-2017	PLAN N°	
DESSIN	Antonio F.	FORMAT	A-2
ECHELLE	Store enrouleur avec coffre B-Box 100 moteur coulisses U-302 Installation laterale Mécanisme: Moteur 40 Barre de charge: Occulte de Ø20mm Tube Ø44mm		
1/1			

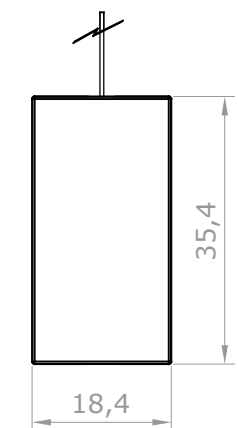
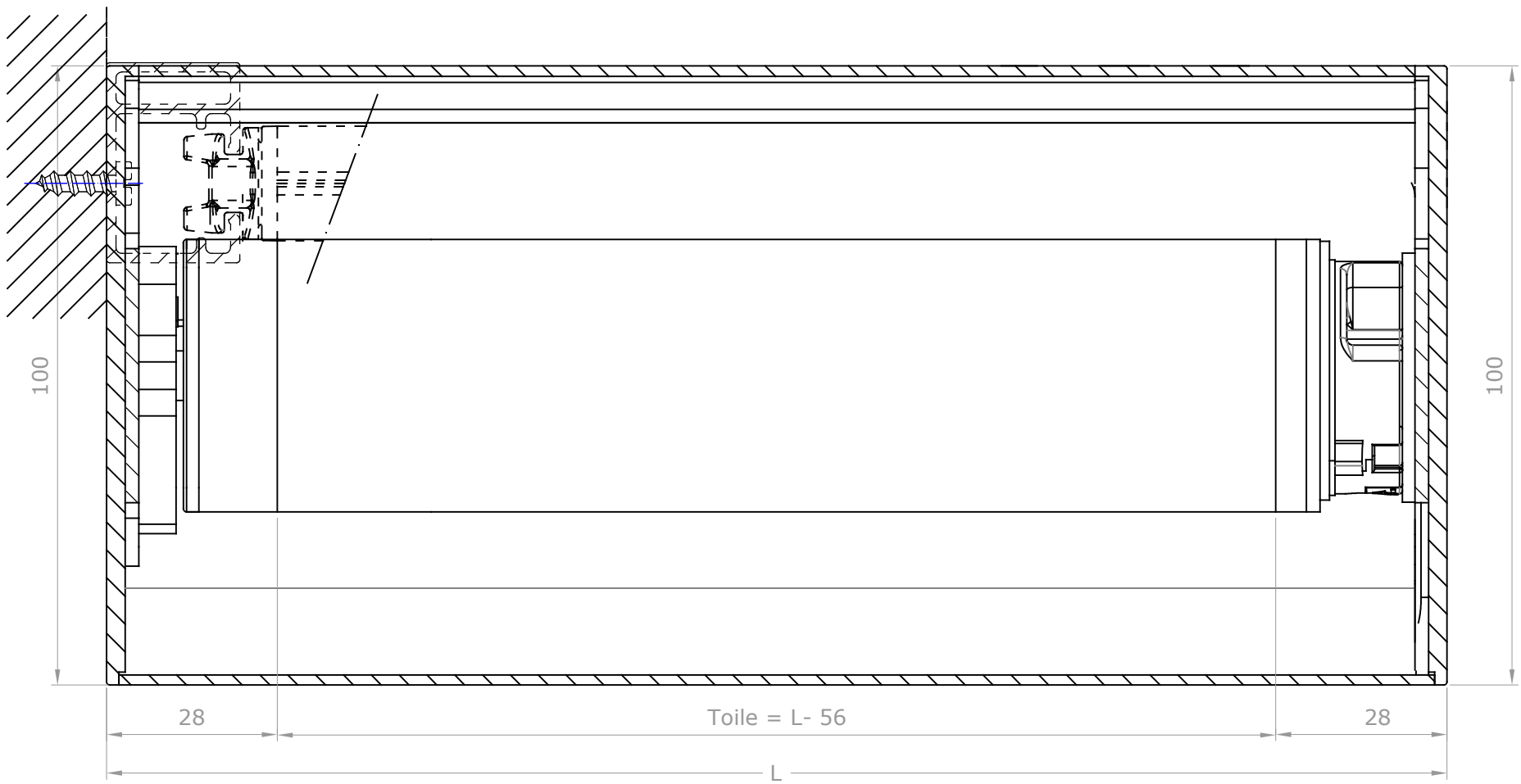
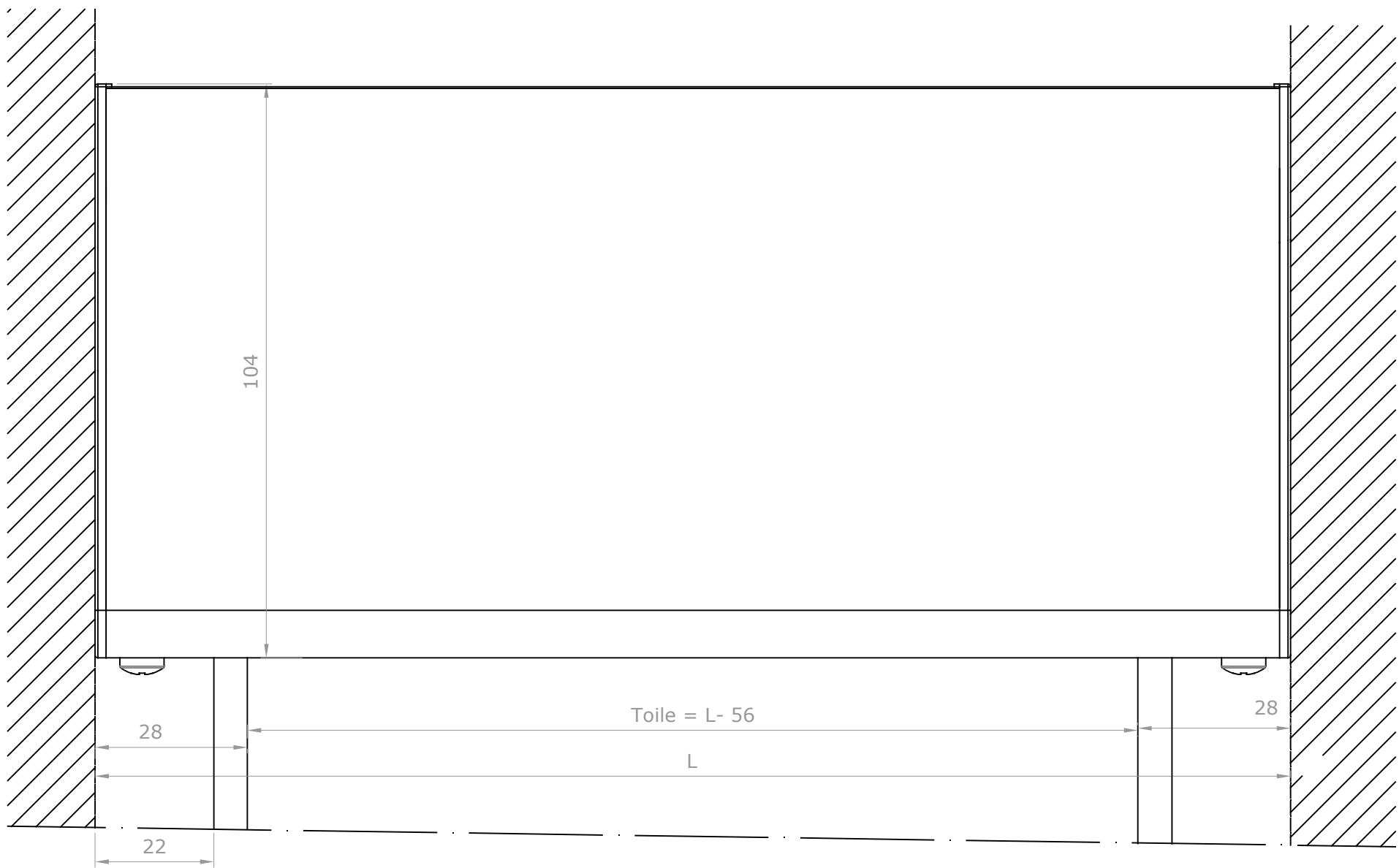

Détail 1:1 barre de charge apparente Slim 35

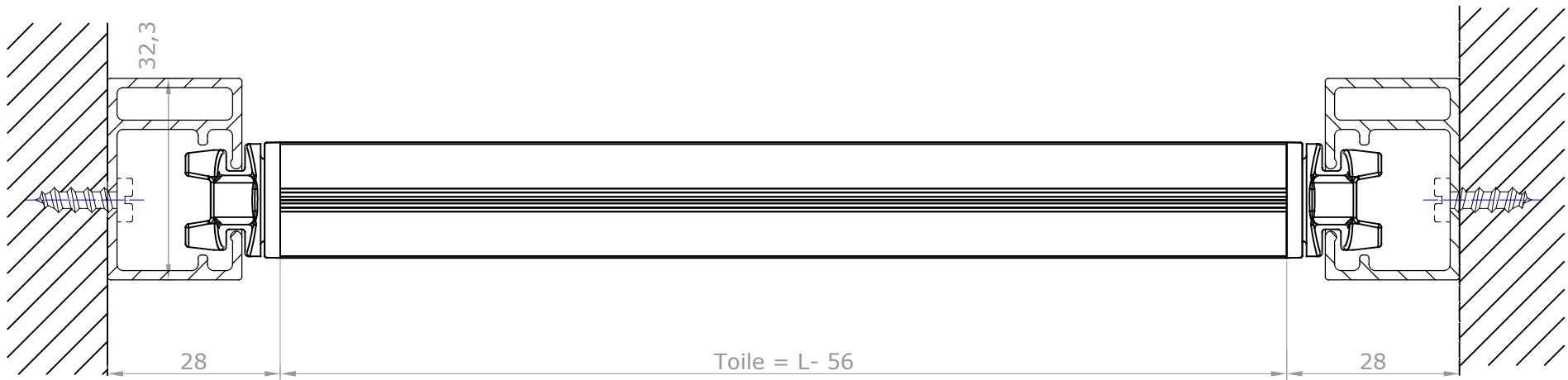

F. REVIS.		BANDALUX	
REVISION	123456789		
DATE	29-06-2017	PLAN N°	
DESSIN	Antonio F.	FORMAT	A-2
ECHELLE	Store enrouleur avec coffre B-Box 100 moteur coulisses U-302 Installation laterale Mécanisme: Moteur 40 Barre de charge: Slim 35 Tube Ø44mm		
1/1			

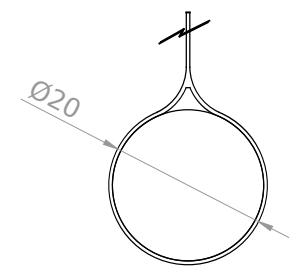
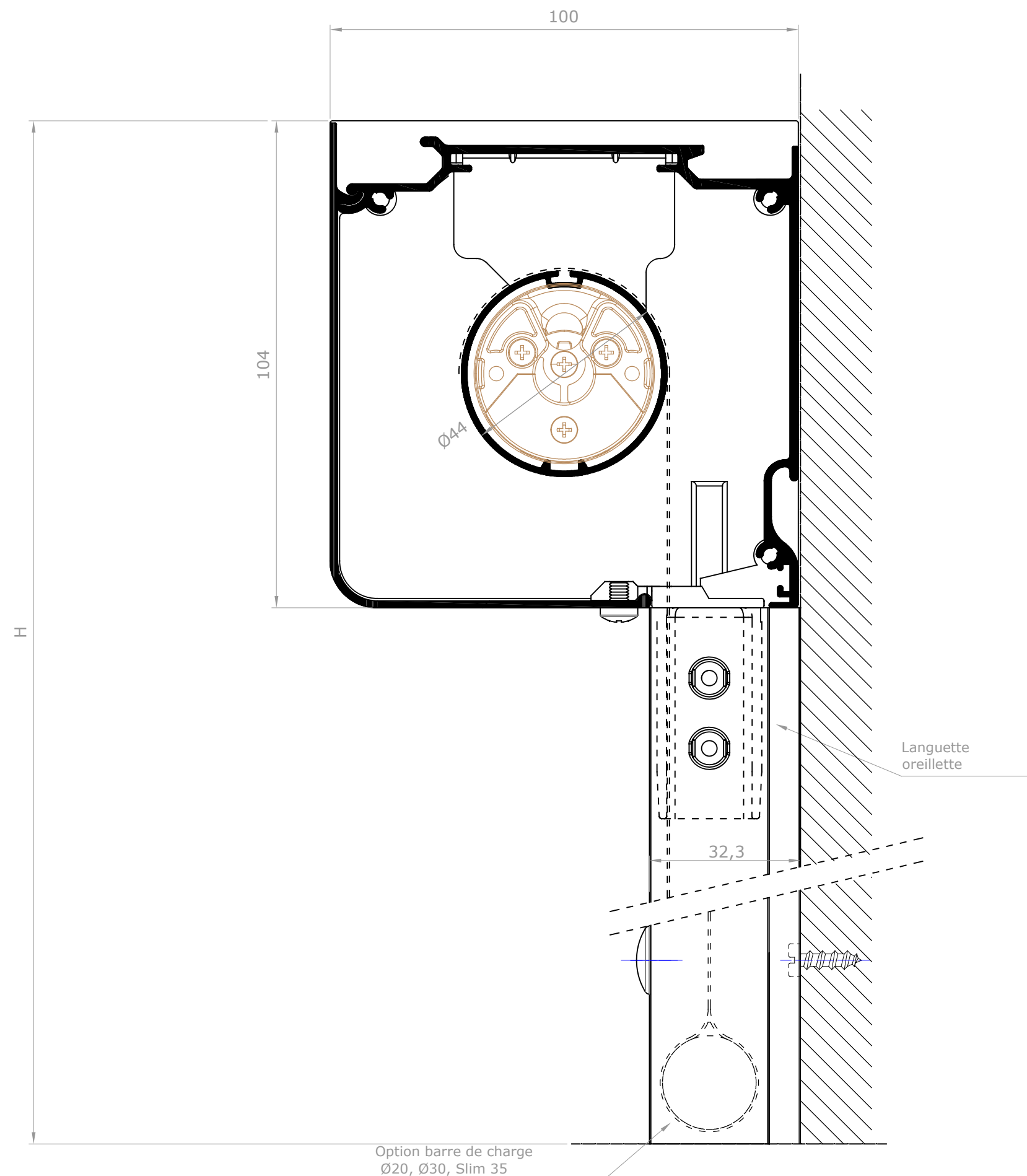

Détail 1:1 barre de charge occulte Ø20

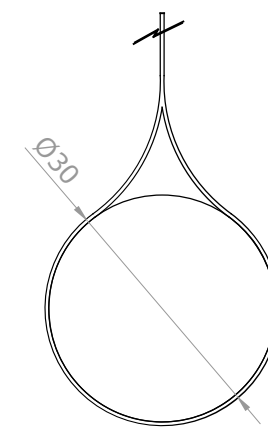

Détail 1:1 barre de charge occulte Ø30



Détail 1:1 barre de charge apparente Slim 35

F. REVIS.		BANDALUX	
REVISION	1 2 3 4 5 6 7 8 9		
DATE	29-06-2017	PLAN N°	
DESSIN	Antonio F.	FORMAT	A-3
ECHELLE	Store enrouleur avec coffre B-Box 100 moteur coulisses U-302 Installation frontale Mécanisme: Moteur 40 Barre de charge: Occulte de Ø20mm Tube Ø44mm		
1/1			

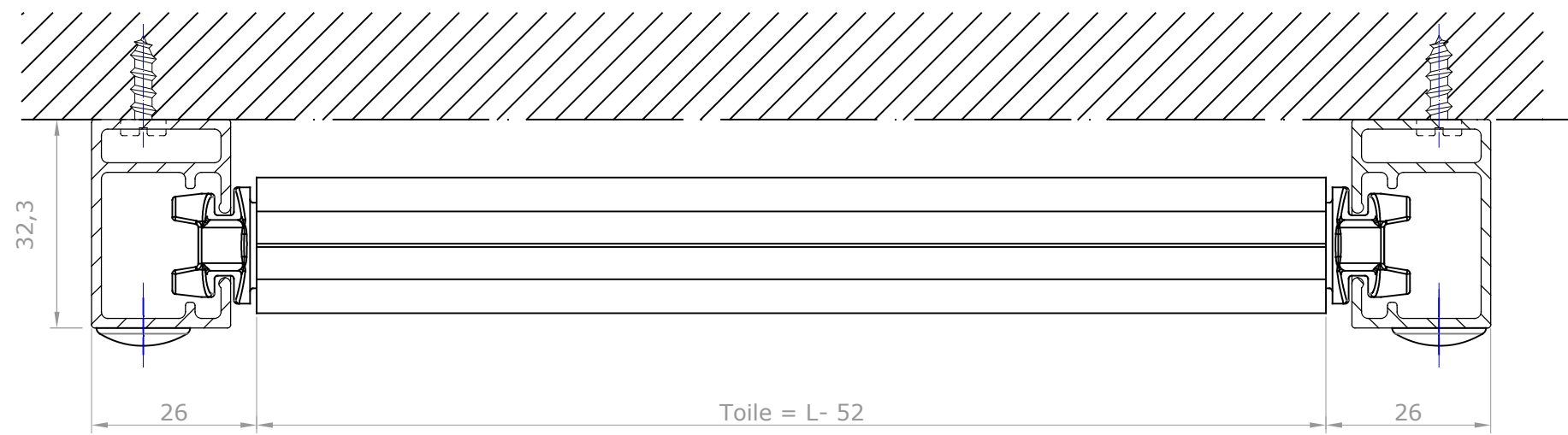
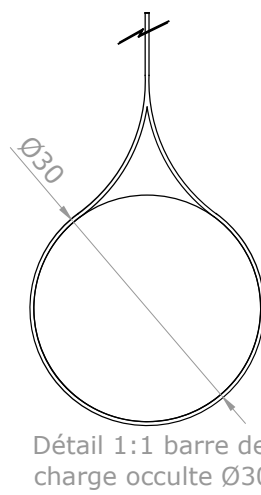
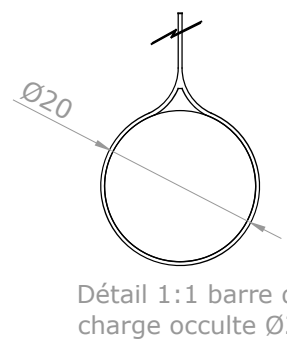
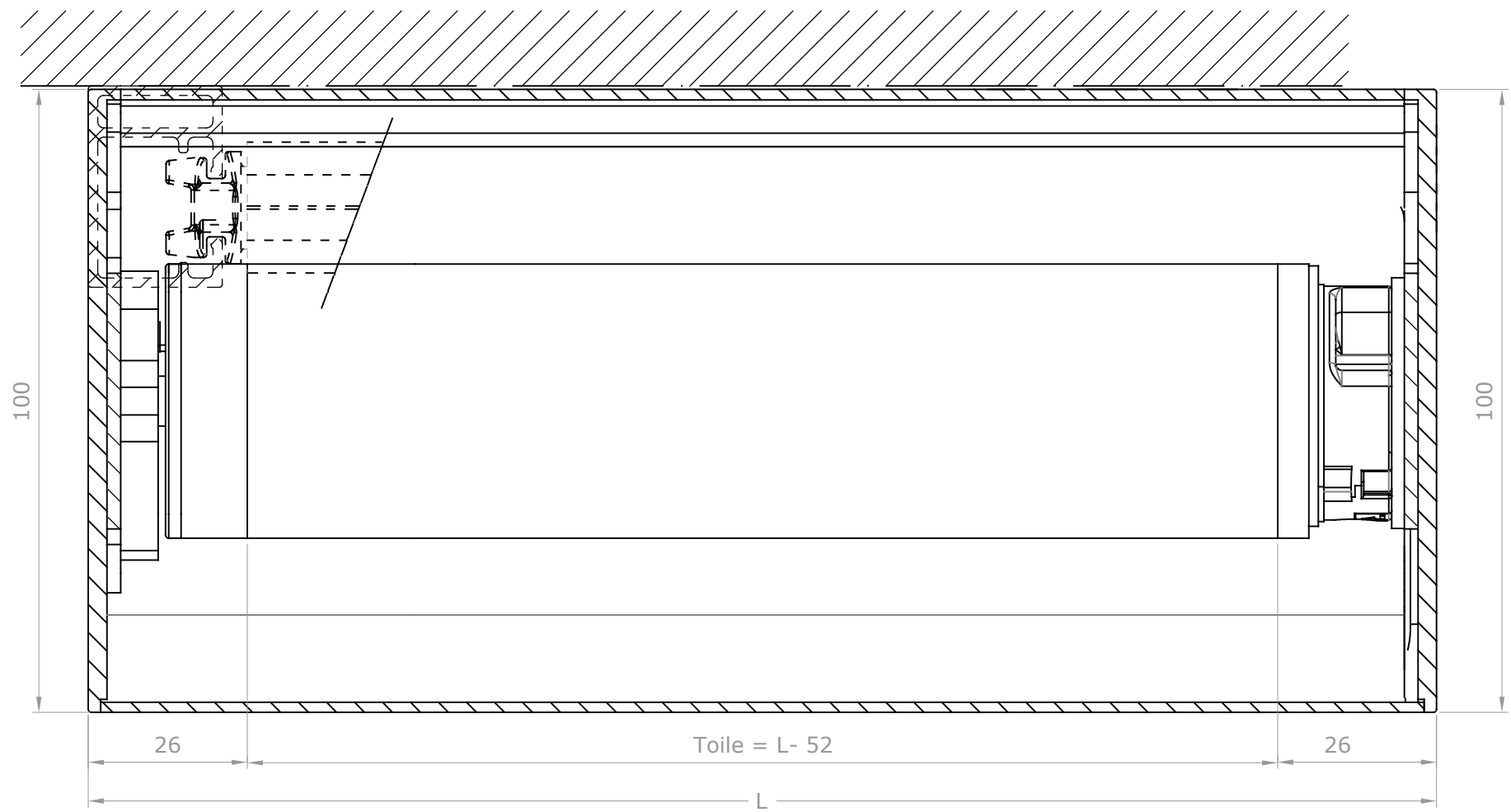
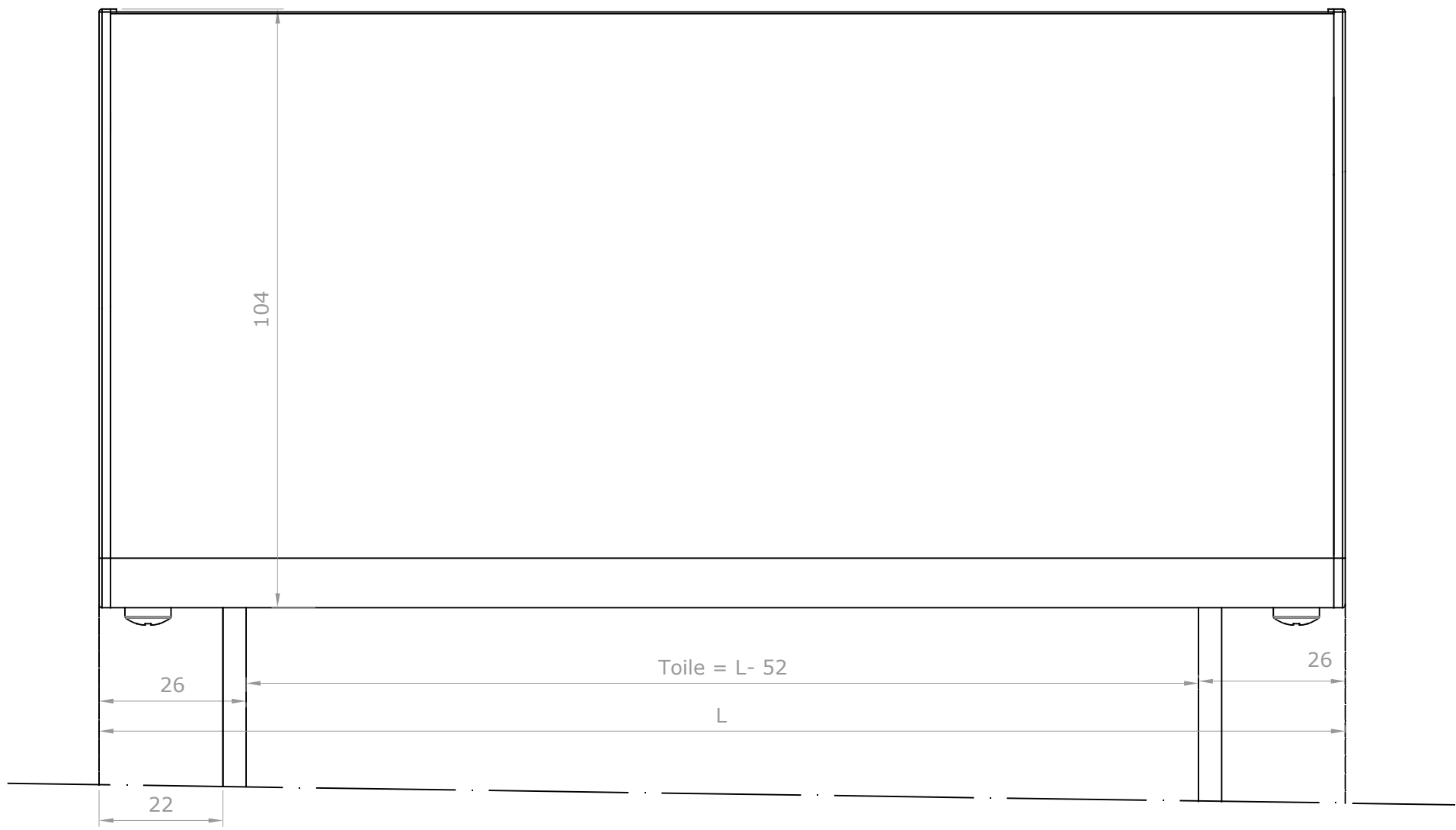

F. REVIS.		BANDALUX	
REVISION	123456789		
DATE	29-06-2017	PLAN N°	
DESSIN	Antonio F.	FORMAT	A-2
ECHELLE	Store enrouleur avec coffre B-Box 100 moteur coulisses U-302 Installation frontale Mécanisme: Moteur 40 Barre de charge: Occulte de Ø20mm Tube Ø44mm		
1/1			

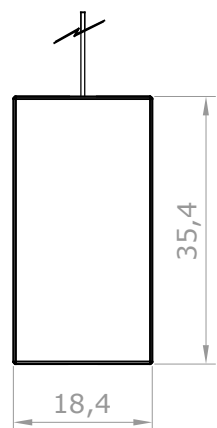
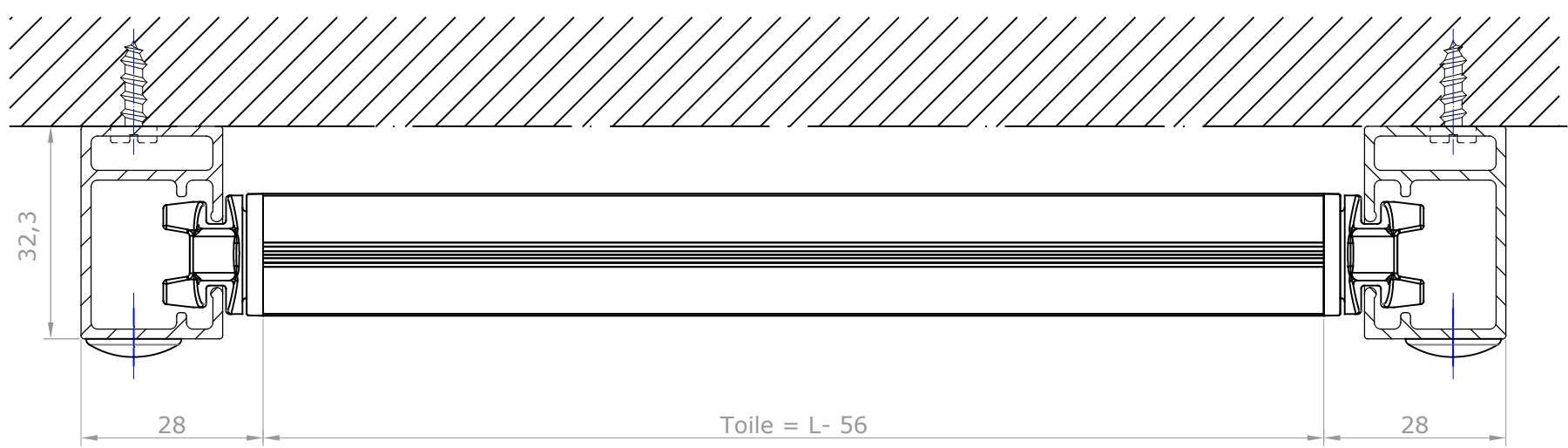
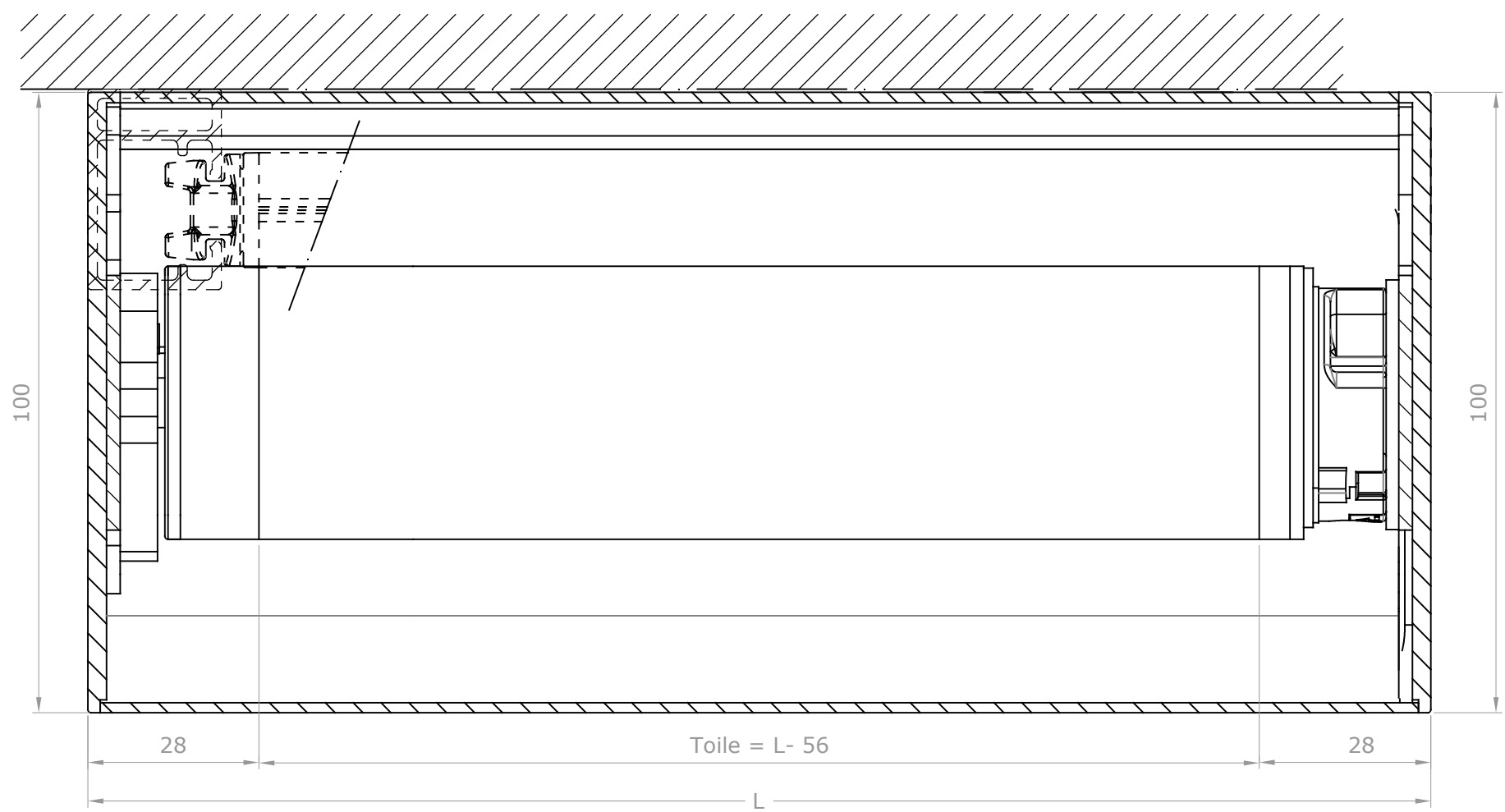
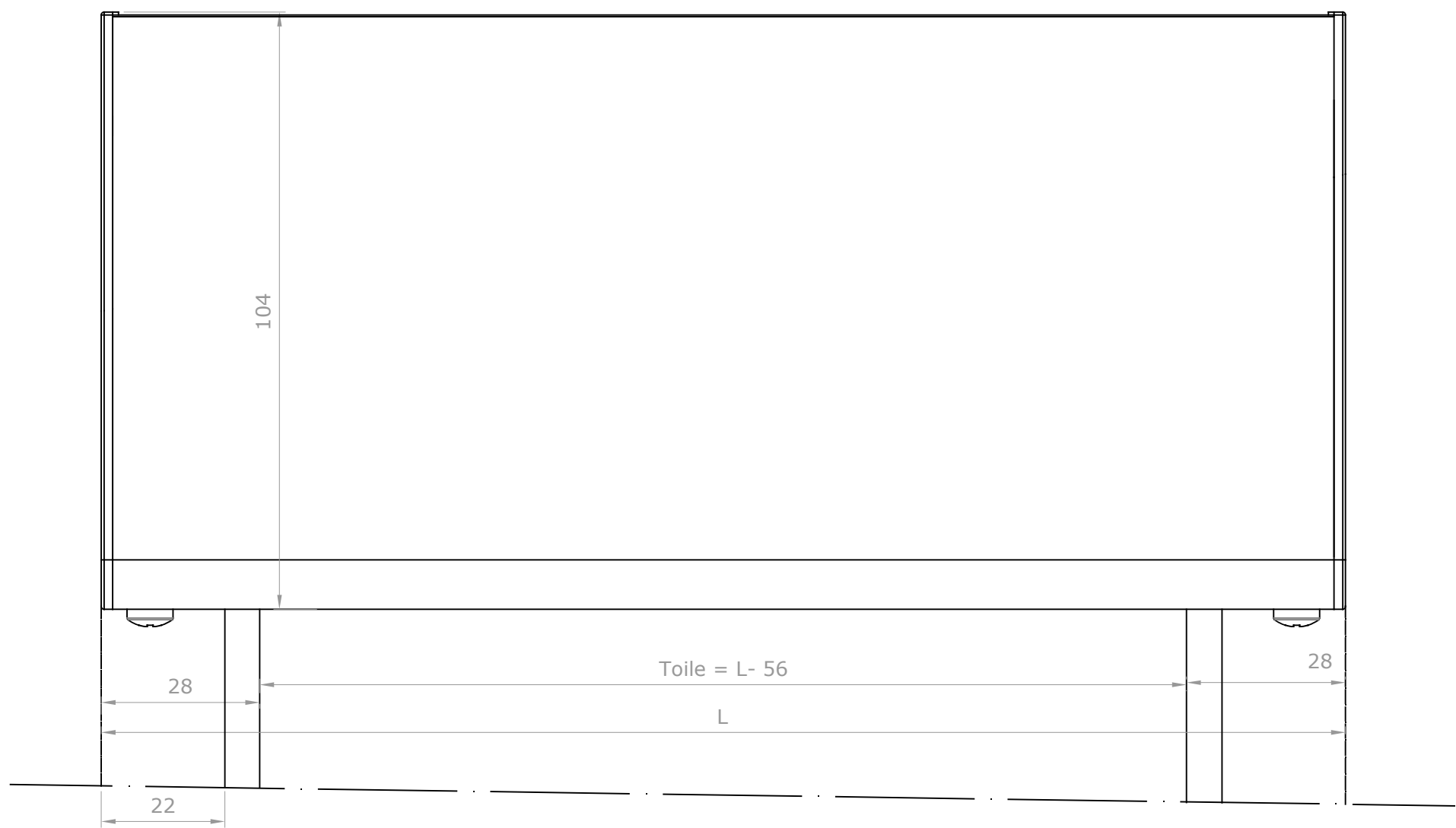

Détail 1:1 barre de charge apparente Slim 35

F. REVIS.		BANDALUX	
REVISION	123456789		
DATE	29-06-2017	PLAN N°	
DESSIN	Antonio F.	FORMAT	A-2
ECHELLE	Store enrouleur avec coffre B-Box 100 moteur coulisses U-302 Installation frontale Mécanisme: Moteur 40 Barre de charge: Slim 35 Tube Ø44mm		
1/1			

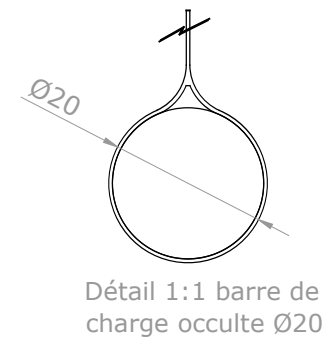
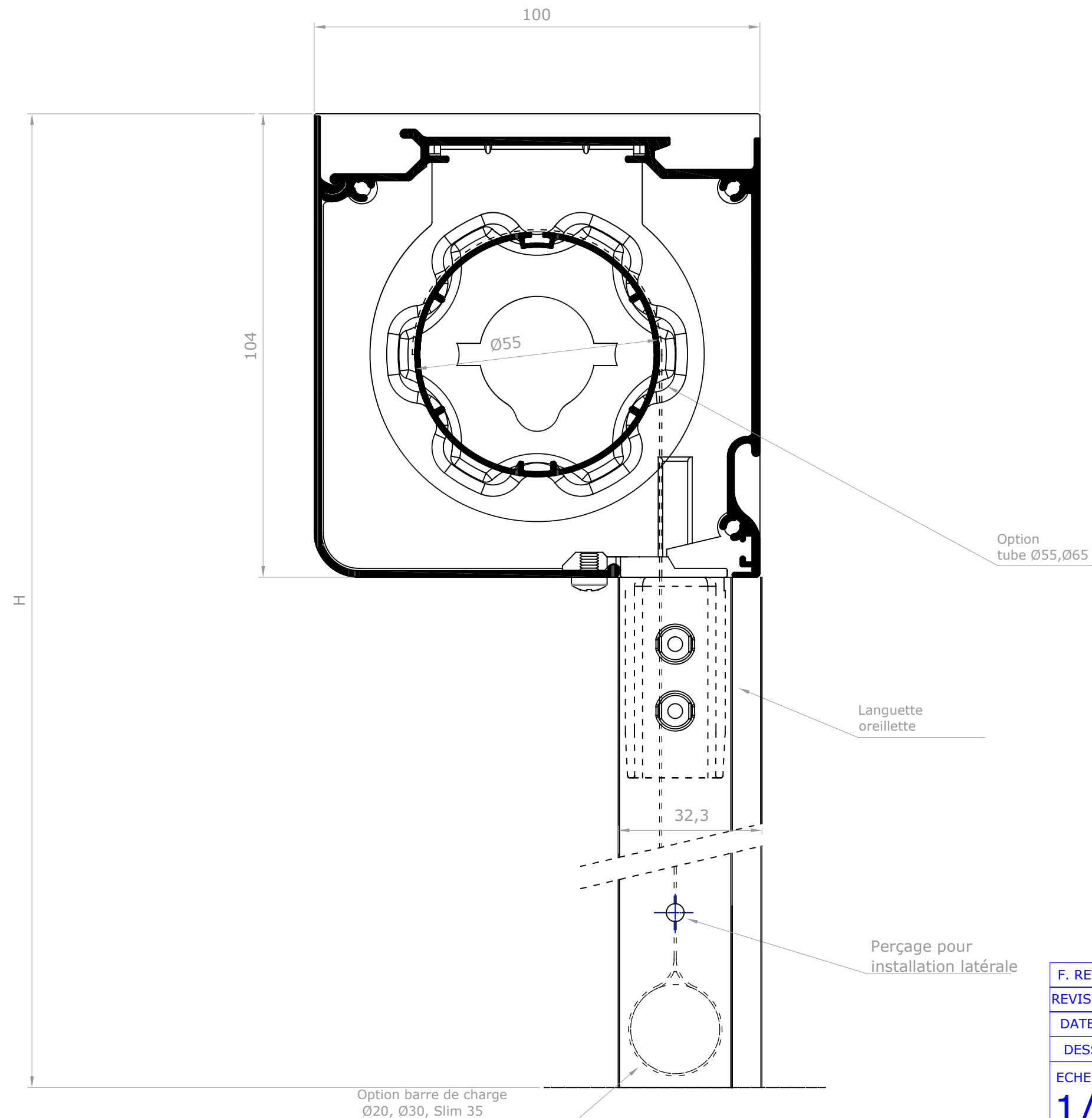

Détail 1:1 barre de charge occulte Ø20

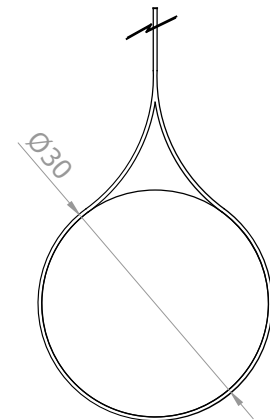

Détail 1:1 barre de charge occulte Ø30

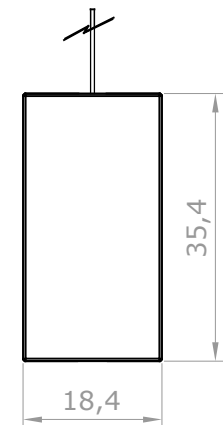

Détail 1:1 barre de charge apparente Slim 35

F. REVIS.		BANDALUX	
REVISION	1 2 3 4 5 6 7 8 9		
DATE	29-06-2017	PLAN N°	
DESSIN	Antonio F.	FORMAT	A-3
ECHELLE	Store enrouleur avec coffre B-Box 100 moteur coulisses U-302		
1/1	Installation latérale		
	Mécanisme: Moteur 50		
	Barre de charge: Occulte de Ø20mm		
	Tube Ø55mm		

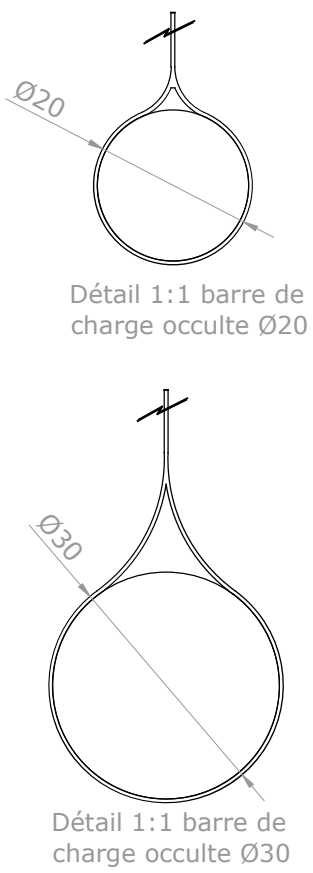
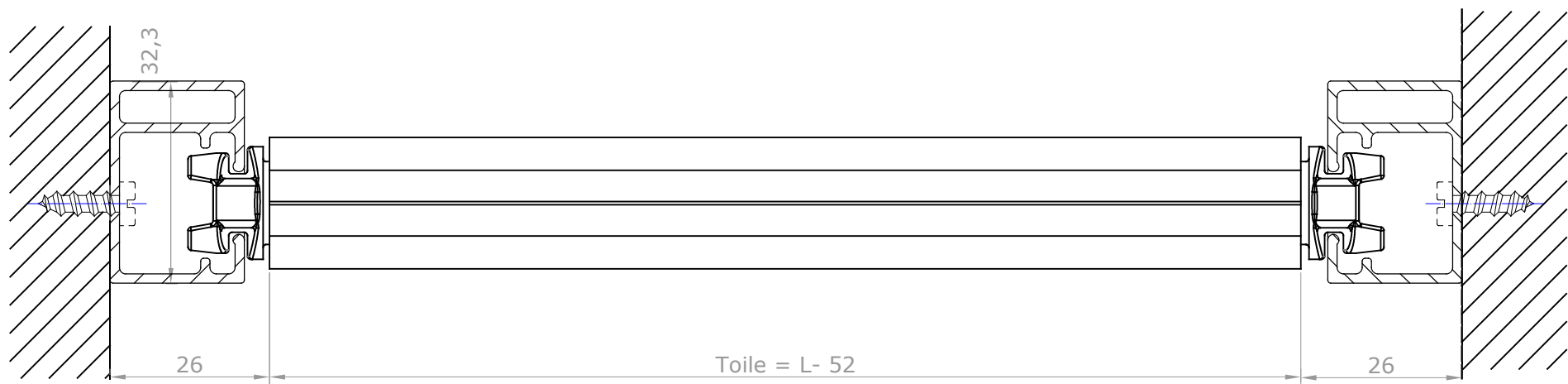
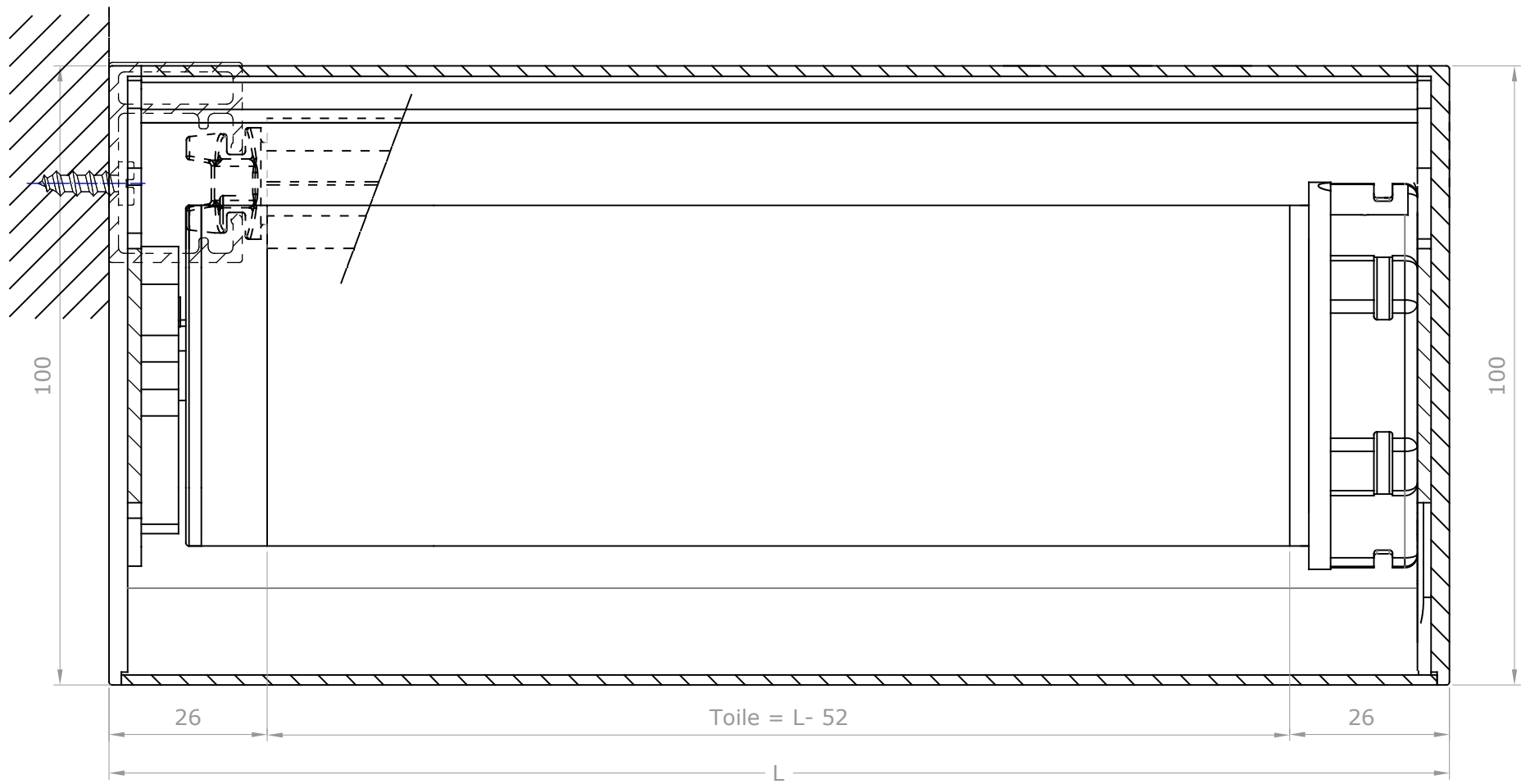
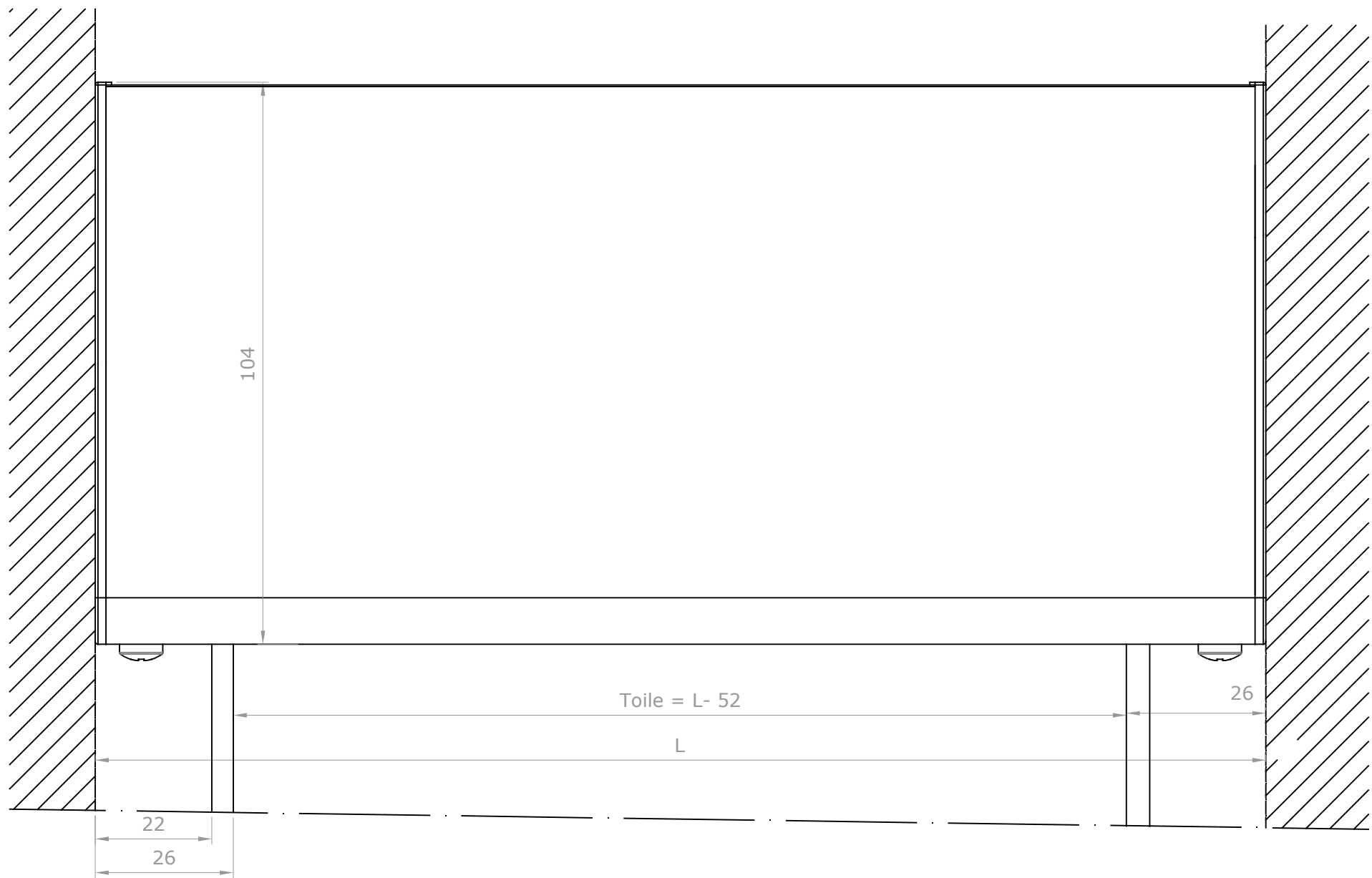

F. REVIS.		BANDALUX	
REVISION	123456789		
DATE	29-06-2017	PLAN N°	
DESSIN	Antonio F.	FORMAT	A-2
ECHELLE	Store enrouleur avec coffre B-Box 100 moteur coulisses U-302 Installation laterale Mécanisme: Moteur 50 Barre de charge: Occulte de Ø20mm Tube Ø55mm		
1/1			



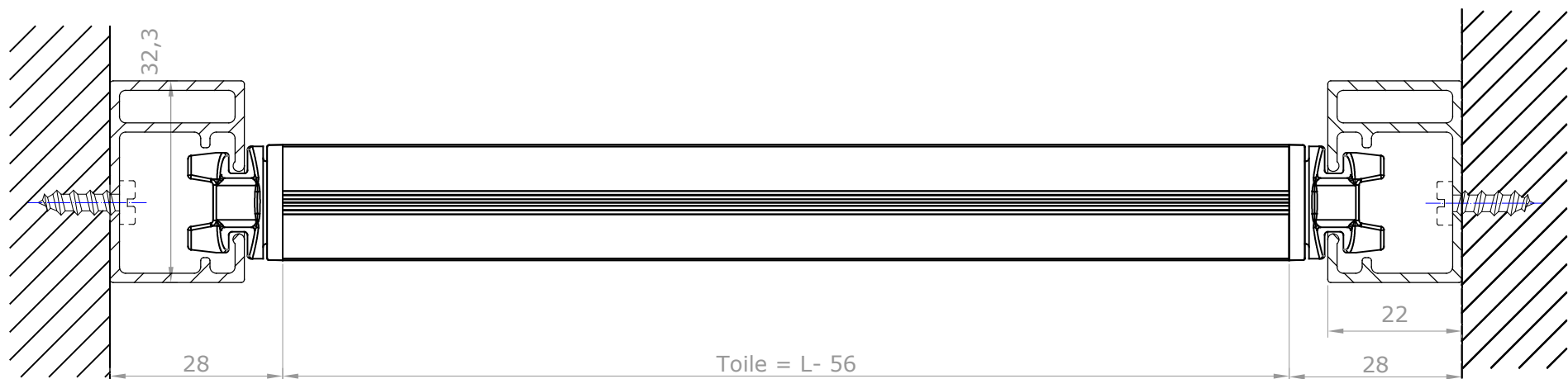
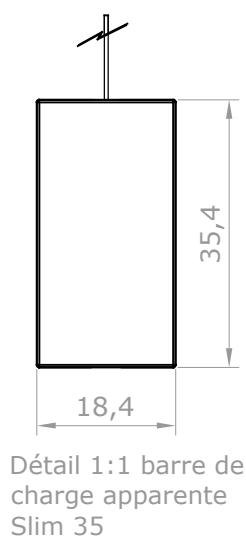
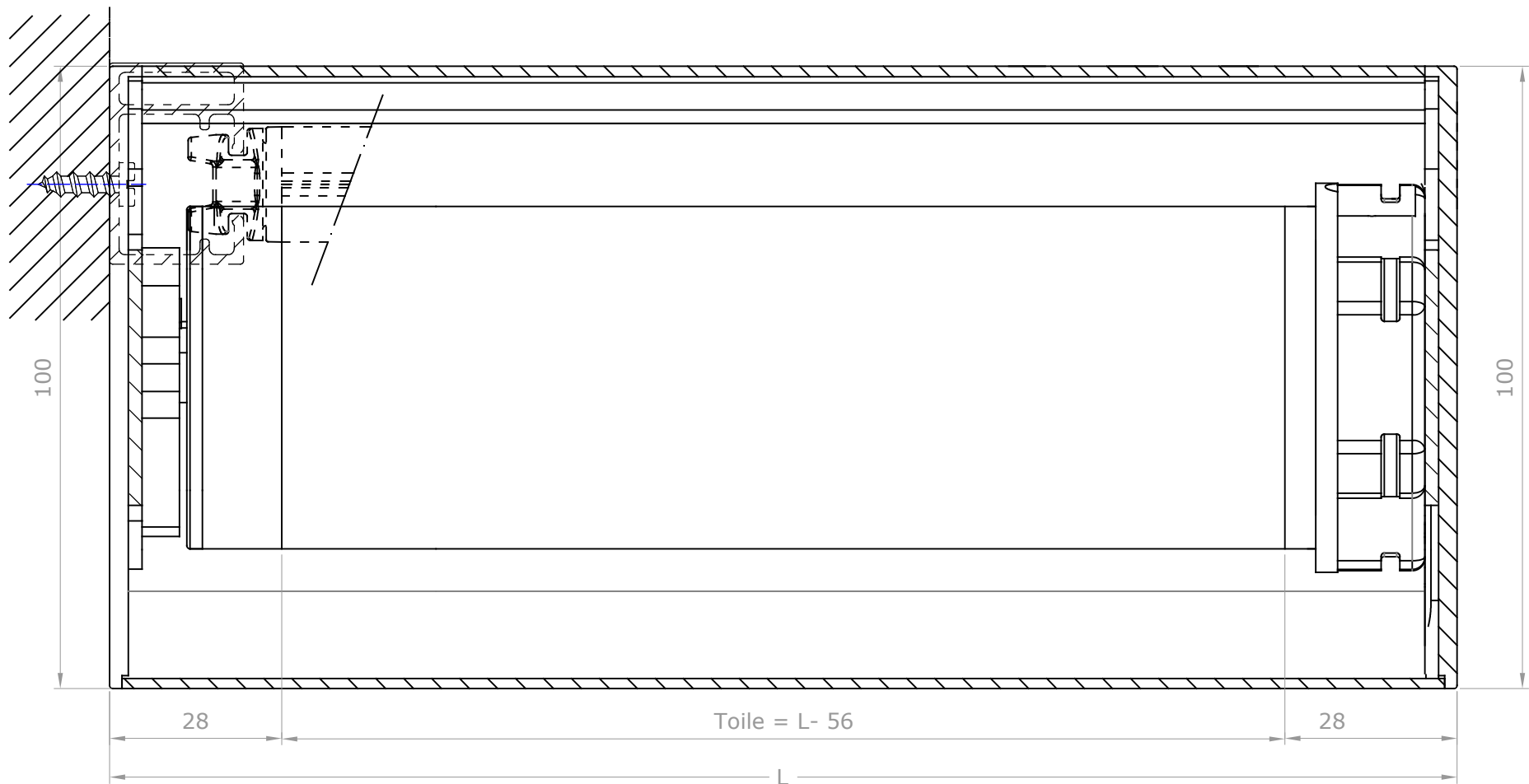
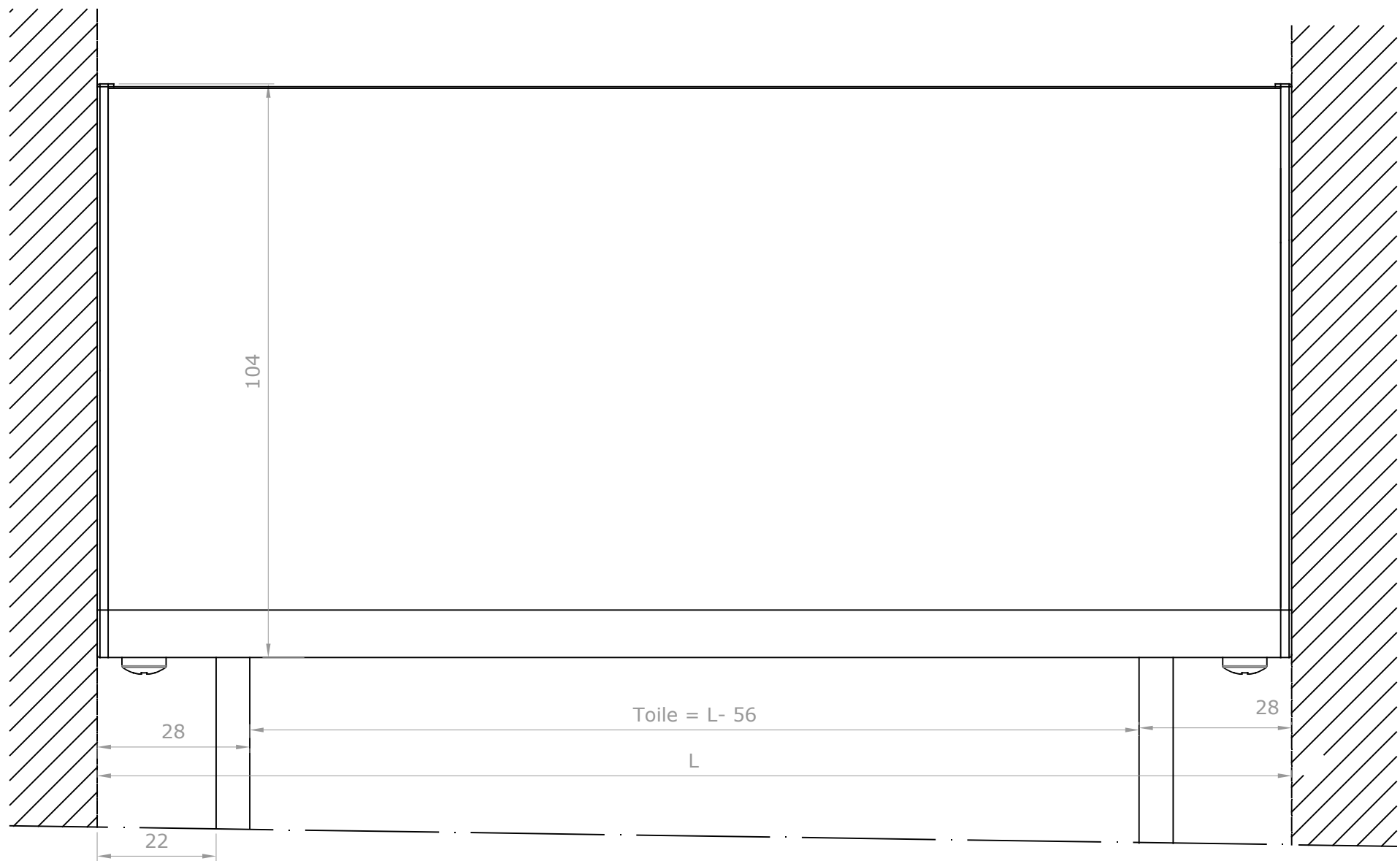

F. REVIS.		BANDALUX	
REVISION	123456789		
DATE	29-06-2017	PLAN N°	
DESSIN	Antonio F.	FORMAT	A-2
ECHELLE	Store enrouleur avec coffre B-Box 100 moteur coulisses U-302 Installation laterale Mécanisme: Moteur 50 Barre de charge: Slim35 Tube Ø55mm		
1/1			

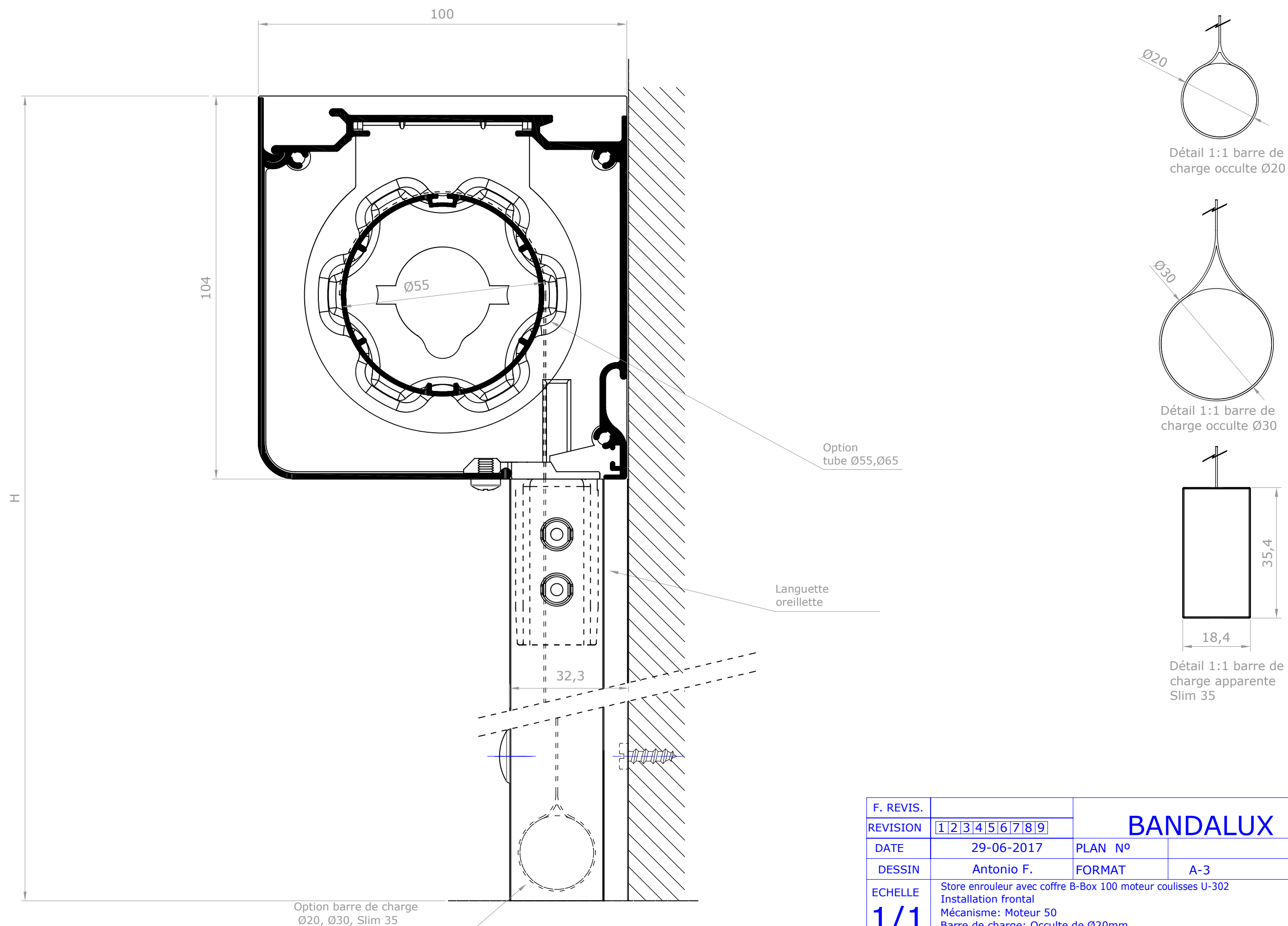

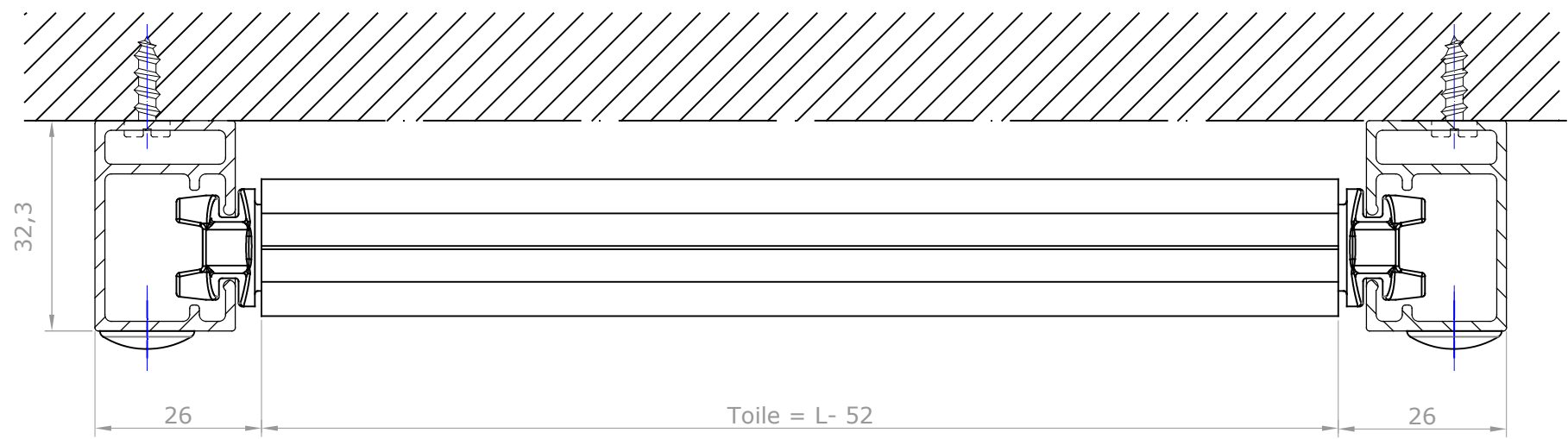
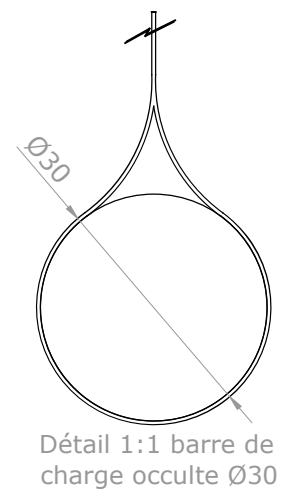
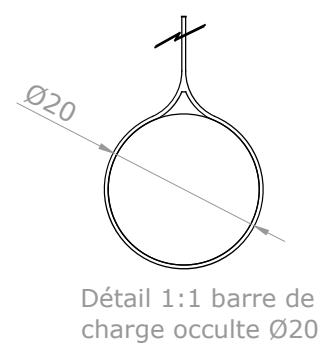
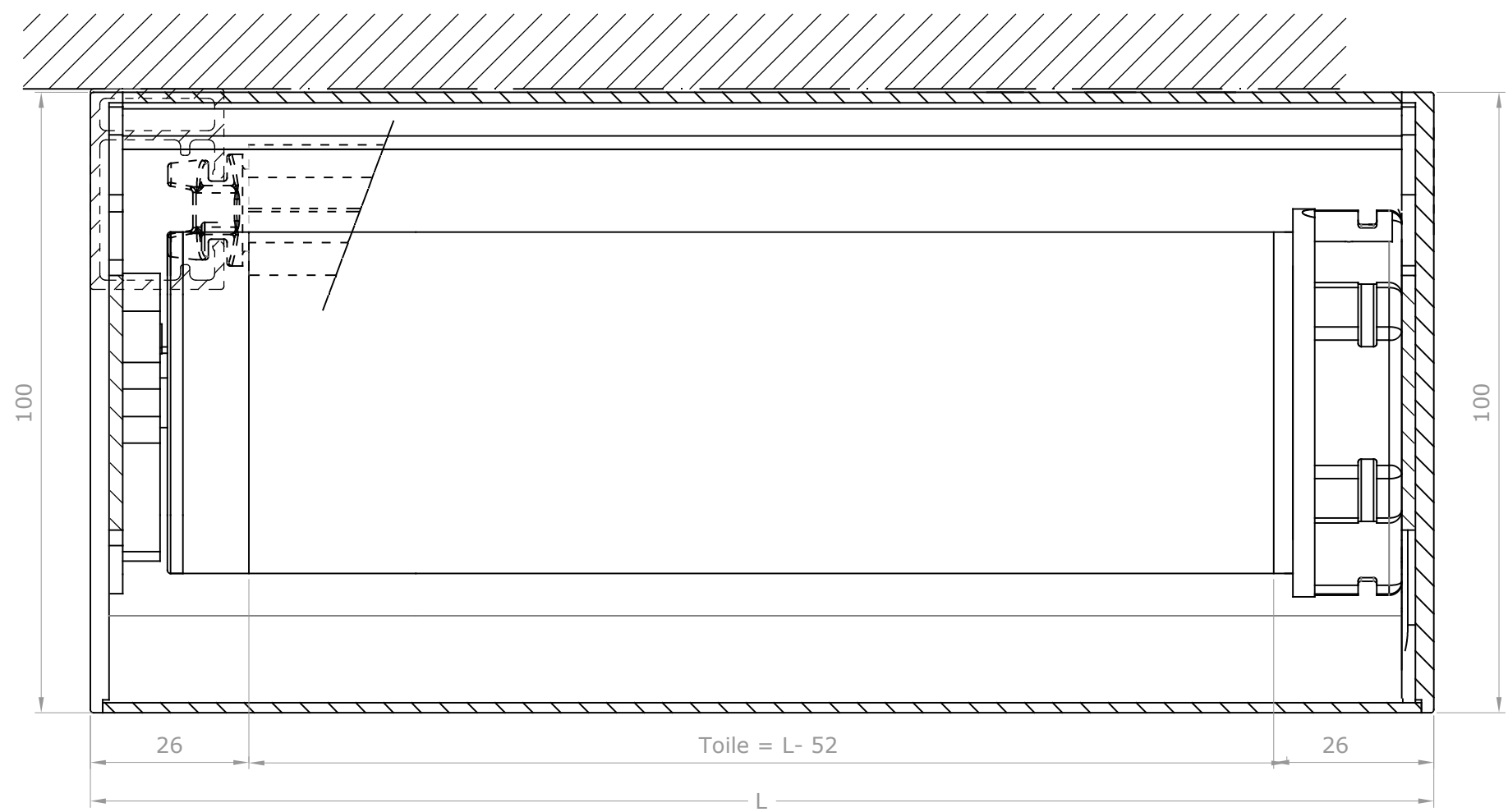
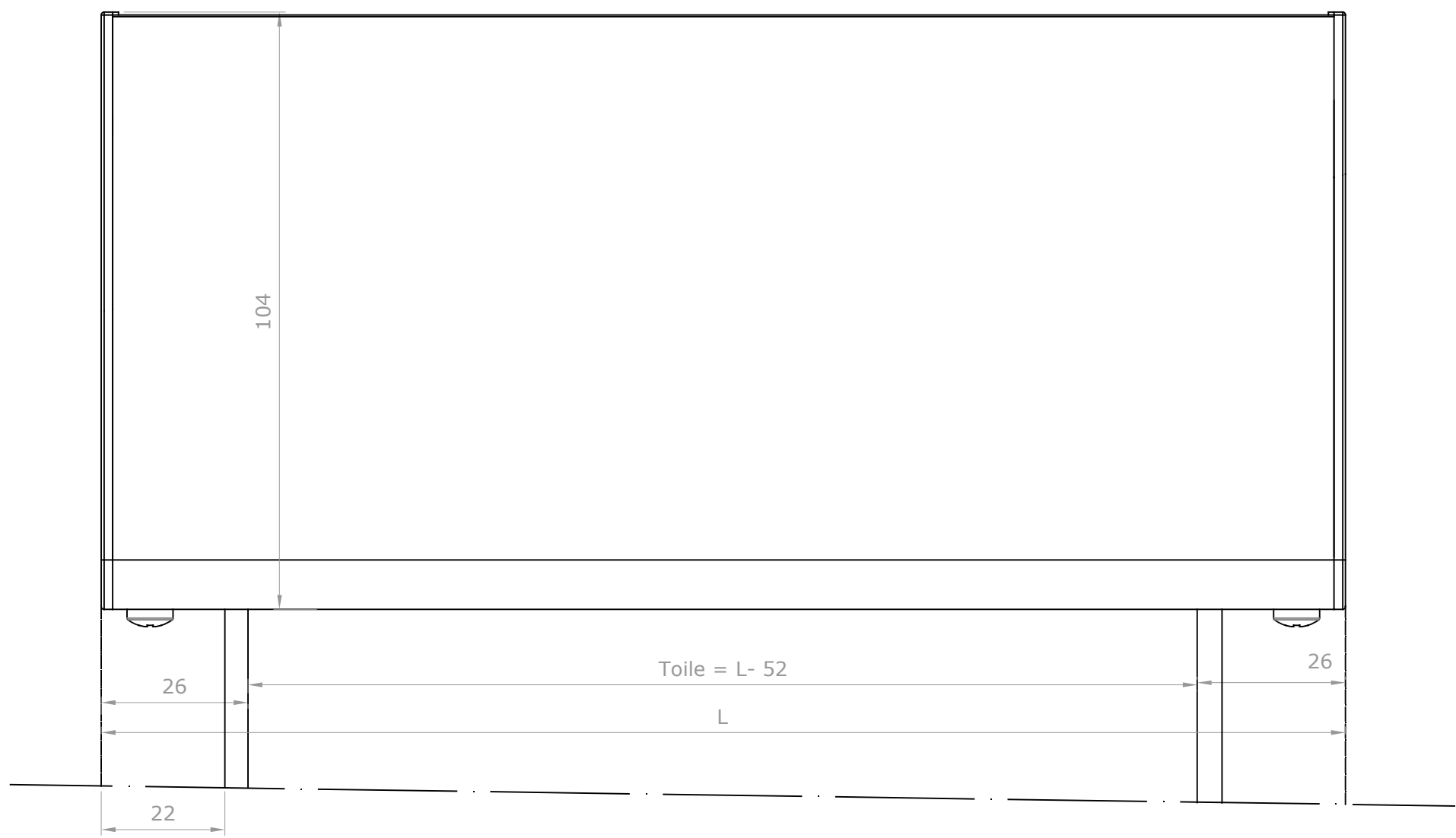

F. REVIS.		BANDALUX	
REVISION	123456789		
DATE	29-06-2017	PLAN N°	
DESSIN	Antonio F.	FORMAT	A-2
ECHELLE	Store enrouleur avec coffre B-Box 100 moteur coulisses U-302 Installation frontal Mécanisme: Moteur 50 Barre de charge: Occulte de Ø20mm Tube Ø55mm		
1/1			

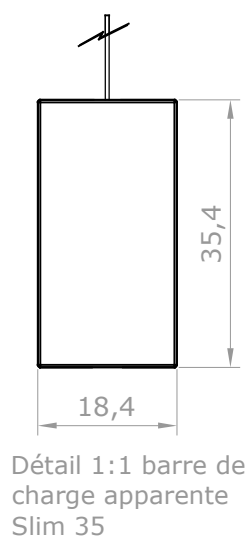
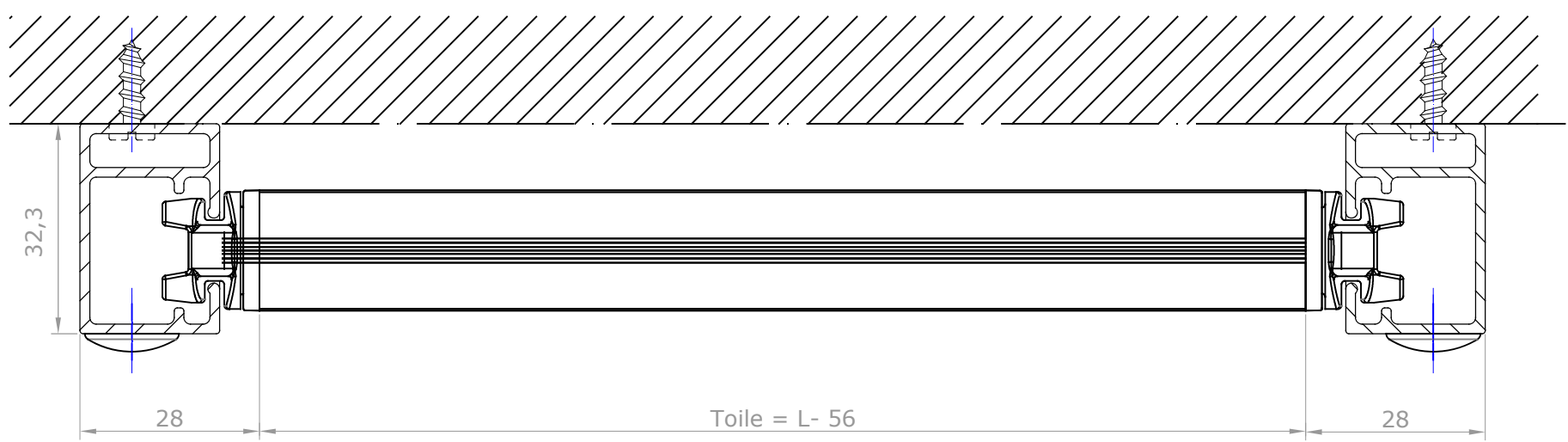
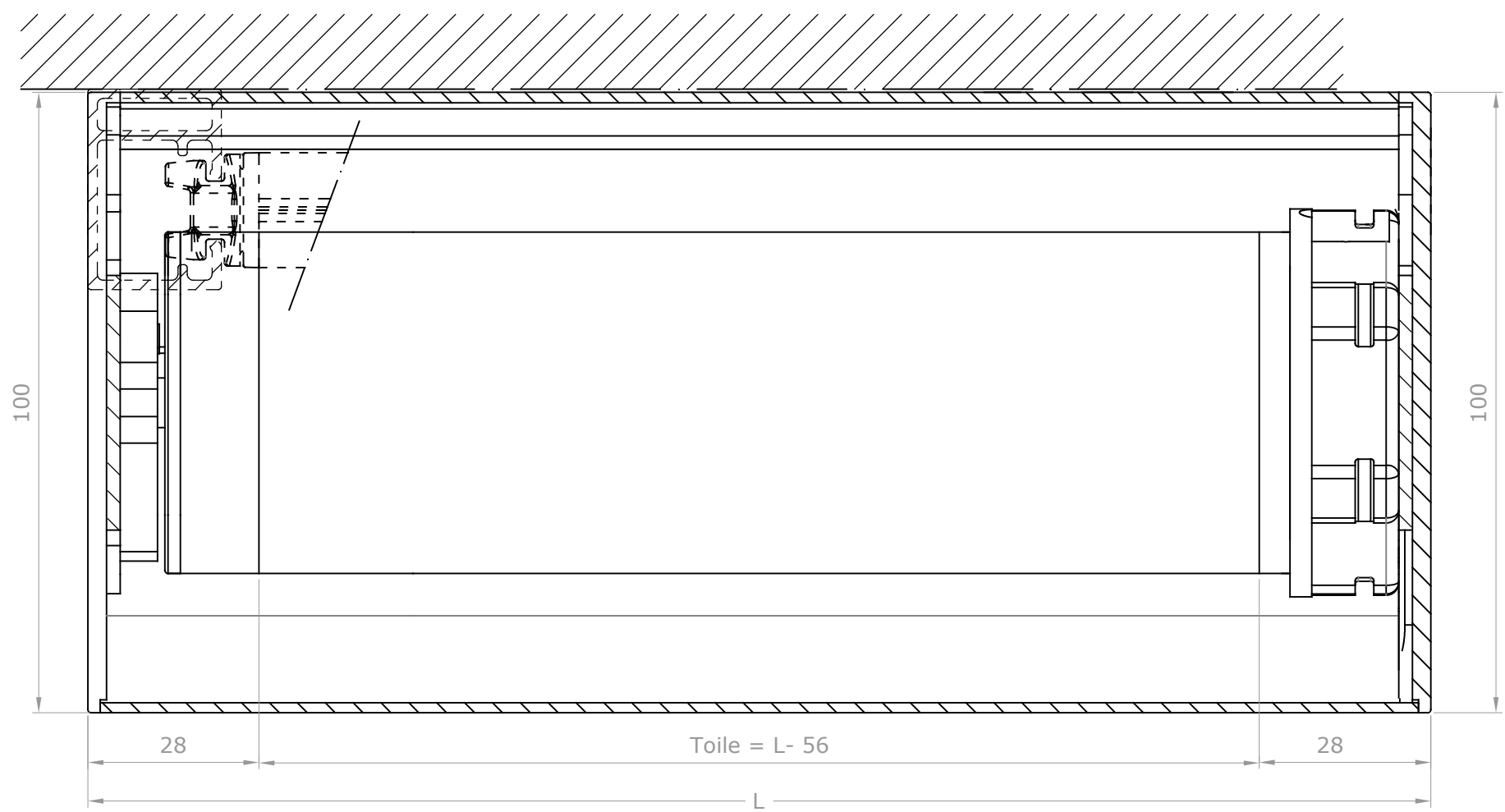
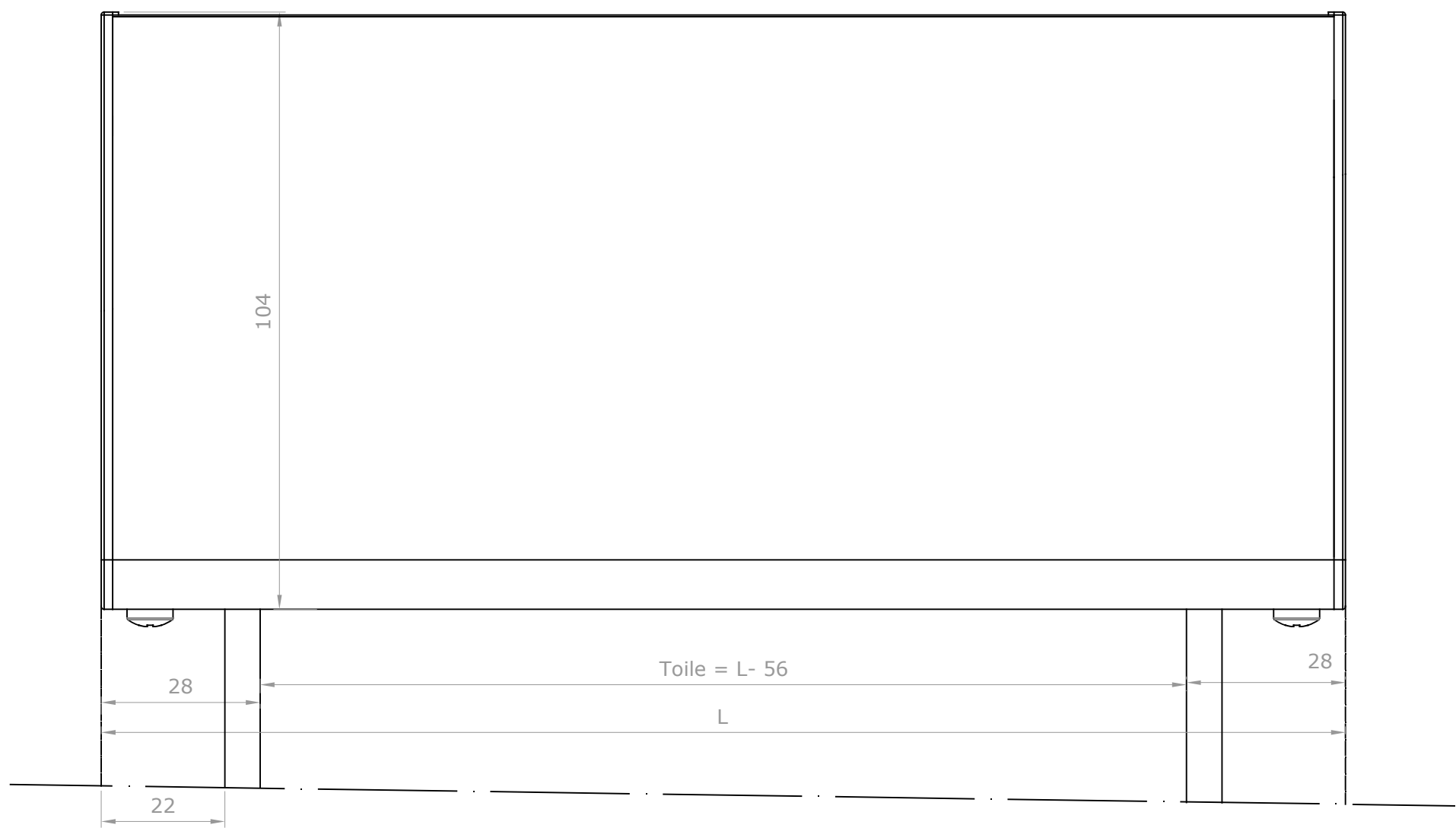

F. REVIS.	BANDALUX		
REVISION			
DATE	29-06-2017	PLAN N°	
DESSIN	Antonio F.	FORMAT	A-2
ECHELLE	Store enrouleur avec coffre B-Box 100 moteur coulisses U-302 Installation frontal Mécanisme: Moteur 50 Barre de charge: Slim 35 Tube Ø55mm		
1/1			